

# ET

Showcase at ventilated refrigeration;  
available in the following versions:  
TN for dairy products, drinks and/or fresh products;  
TB for ice-cream and/or frozen foods



*your visible value*

Small and functional display unit could be placed in the strategic points of the shop, where customers' circulation is very high. ET can be used for the promotion of impulse products increasing considerably the sale's volumes. ET has been studied to be easily branded without interfering with the visibility of the product displayed.



mod. 100

- Models available;  
**normal temperature:** ET TN 70, 100, 100S, 100 TW  
**low temperature:** ET TB 70, 100, 100TW
- Structure in ABS
- Bumper in PVC
- Dome to protect air flow
- Good proportion between display volume and its dimensions
- Panoramic glass sides
- Ventilated refrigeration
- Illuminated canopy - possibility of branding
- Dividers kit for refrigerated display area
- Collection and evaporation system of the condense water
- Rollers



mod. 100 TW

# ET

## QUALITY

Quality to us means flexible design, perfection of details and total reliability over time. Such goals can be obtained only through professionalism and passion of hundreds of ISA men, continuously working to increase the levels of customers' satisfaction.

## VERSATILITY

ET is suitable for bars, stations, as well as groceries and supermarkets. Rollers system allows an easy



ET TN 70



Personalisation on request

Showcase at ventilated refrigeration;  
available in the following versions:  
TN for dairy products, drinks and/or fresh products;  
TB for ice-cream and/or frozen foods



your visible value

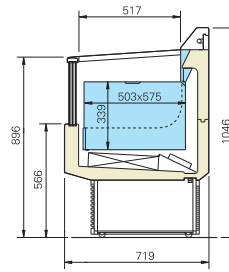

ET 70 TN

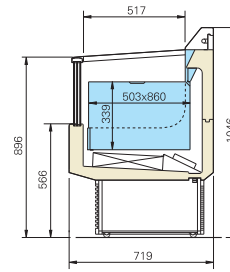

ET 100 TN

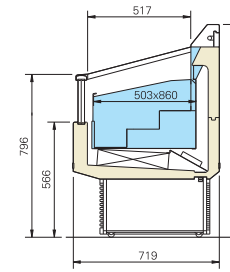

ET 100 TN S

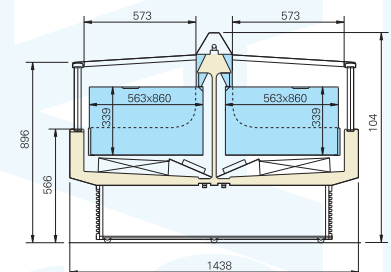

ET 100 TN TW

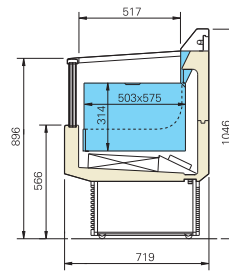

ET 70 TB

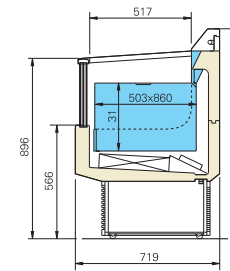

ET 100 TB

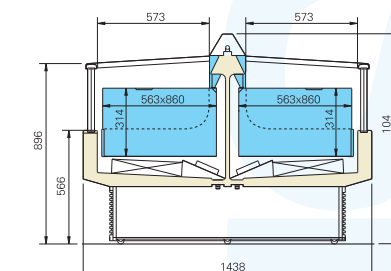

ET 100 TB TW



ISA S.p.A.  
Via del Lavoro, 5  
06083 Bastia Umbra (Pg) - Italy  
tel +39 075 80171 - fax +39 075 8017304  
[www.isaitaly.com](http://www.isaitaly.com)

## Technical features

|                                     | 70 TN           | 100 TN          | 100 TN S        | 100 TN TW       | 70 TB        | 100 TB        | 100 TB TW      |
|-------------------------------------|-----------------|-----------------|-----------------|-----------------|--------------|---------------|----------------|
| LxDxH mm                            | 716x719x1046    | 1000x719x1046   | 1000x719x1046   | 1000x1438x1046  | 716x719x1046 | 1000x719x1046 | 1000x1438x1046 |
| Capacity (gross/net) lt             | 188/100         | 282/150         | 282/146         | 606/336         | 188/90       | 288/136       | 606/290        |
| Product temperature °C              | +2 / +5         | +2 / +5         | +1 / +4         | +2 / +5         | -18 / -16    | -18/-16       | -18/-16        |
| Refrigeration                       | ventilated      | ventilated      | ventilated      | ventilated      | ventilated   | ventilated    | ventilated     |
| Defrosting                          | stop compressor | stop compressor | stop compressor | stop compressor | hot gas      | hot gas       | hot gas        |
| Operating climatic class N°°C/%R.H. | 3 / 25 / 60     | 3 / 25 / 60     | 3 / 25 / 60     | 3 / 25 / 60     | 4 / 30 / 55  | 4 / 30 / 55   | 4 / 30 / 55    |
| Electrical input (standard) W       | 330             | 400             | 400             | 410             | 600          | 690           | 1300           |
| Electrical input (defrosting) W     | 130             | 130             | 130             | 130             | 1800         | 1500          | 1900           |
| Net weight kg                       | 83              | 98              | 98              | 197             | 83           | 98            | 197            |

Due to the quality advancement programmes and continuous scientific research ISA reserves the right to modify any technical specifications without notice.